



DATE SUBMITTED February 9, 2022
 SUBMITTED BY R. Alejandro Estrada
 DATE ACTION REQUIRED February 16, 2022

COUNCIL ACTION (X)
 PUBLIC HEARING REQUIRED ()
 RESOLUTION ()
 ORDINANCE 1ST READING ()
 ORDINANCE 2ND READING ()
 CITY CLERK'S INITIALS AB

**IMPERIAL CITY COUNCIL
 AGENDA ITEM**

SUBJECT: DISCUSSION/ACTION: APPROVAL OF FIVE (5) YEAR LEASE CONTRACT WITH CANON SOLUTIONS AMERICA, INC. FOR A PRINTER AND PLOTTER	
DEPARTMENT INVOLVED: DEPARTMENT OF INFORMATION TECHNOLOGY	
BACKGROUND/SUMMARY: Staff is requesting authorization for a five (5) year lease contract with Canon Solutions America, Inc. in the amount of 324.00 per month. This contract includes one (1) laser printer LBP1538c for the Administrative Services Department and one (1) plotter TZ-30000 MFP-Z36 for the Community Development Department. Although we planned to include these two items in the 2022-2023 budget, we need to replace the existing devices that presented irreparable damage.	
FISCAL IMPACT: NOT TO EXCEED General Fund impact for FY 2021-2022: \$ 1,495.00 Enterprise Fund impact for FY 2021-2022: \$ 125.00	FINANCE INITIALS 
STAFF RECOMMENDATION: After the review and consideration by the Department of Information Technology , it is recommended the City Council approve the use of funds allocated to pay these services.	DEPT. INITIALS 
MANAGER'S RECOMMENDATION:	CITY MANAGER'S INITIALS 
MOTION: SECONDED: APPROVED () REJECTED () AYES: DISAPPROVED () DEFERRED () NAYES: ABSENT: REFERRED TO:	



Canon Solutions America, Inc. ("CSA")
 One Canon Park, Melville, NY 11747
 (800) 613-2228

**Master Sales & Services Agreement
 Customer Information Face Page**

MA22995

Salesperson: D Andrew Leptich Order Date: 2/2/2022

Customer ("you"):

Company: CITY OF IMPERIAL		
Address: 420 S IMPERIAL AVE		
City: IMPERIAL	County: IMPERIAL	
State: CA	Zip: 92251-1637	Phone #: 760.355.3842
Contact: ALEJANDRO ESTRADA		Fax #:
Email: AESTRADA@CITYOFIMPERIAL.ORG		

Applicable Terms and Conditions	Customer Organizational Information
<p>TERMS AND CONDITIONS ARE AVAILABLE AT: ESS.CSA.CANON.COM/CUSTOMERDOCUMENTS</p> <p>The CSA customer terms and conditions located at the above website ("Terms") form part of this Agreement. The Terms include general terms, and terms for product and service purchase, maintenance, support and leasing (pursuant to the terms of Rider G); managed print services; and quotes. The Terms applicable to each of your transactions will be referenced in the Order Schedule.</p> <p>By your initials herein and signature below, you understand and acknowledge such Terms and agree to comply with those applicable to each Order Schedule.</p> <p>Customer Initials _____</p>	<p>Federal Tax ID Number: _____</p> <p>Organization type: State or Local Government</p> <p>Address for Notices: Attn: ALEJANDRO ESTRADA Address: 420 SOUTH IMPERIAL AVENUE Address 2: City: IMPERIAL State: CA Zip: 92251 Email: AESTRADA@CITYOFIMPERIAL.ORG</p>
<p>BY YOUR SIGNATURE BELOW, YOU AGREE TO LEASE, PURSUANT TO THE TERMS OF RIDER G, OR PURCHASE, AS SPECIFIED IN THIS AGREEMENT, THE ITEMS LISTED IN ANY SCHEDULE, RIDER OR ADDENDA (AS APPROVED BY CSA) TO THIS AGREEMENT. YOU ACKNOWLEDGE RECEIPT OF A COPY OF THIS AGREEMENT, AND AGREE TO ABIDE BY ALL OF THE TERMS AND CONDITIONS OF THIS FACE PAGE, APPLICABLE SCHEDULE(S), RIDER(S) AND SUCH ADDENDA, THE QUOTE, AND THE APPLICABLE TERMS AND CONDITIONS IDENTIFIED ABOVE, ALL OF WHICH IS INCORPORATED HEREIN AND MADE PART OF THIS AGREEMENT.</p>	

BY YOUR SIGNATURE BELOW, YOU AGREE TO LEASE, PURSUANT TO THE TERMS OF RIDER G, OR PURCHASE, AS SPECIFIED IN THIS AGREEMENT, THE ITEMS LISTED IN ANY SCHEDULE, RIDER OR ADDENDA (AS APPROVED BY CSA) TO THIS AGREEMENT. YOU ACKNOWLEDGE RECEIPT OF A COPY OF THIS AGREEMENT, AND AGREE TO ABIDE BY ALL OF THE TERMS AND CONDITIONS OF THIS FACE PAGE, APPLICABLE SCHEDULE(S), RIDER(S) AND SUCH ADDENDA, THE QUOTE, AND THE APPLICABLE TERMS AND CONDITIONS IDENTIFIED ABOVE, ALL OF WHICH IS INCORPORATED HEREIN AND MADE PART OF THIS AGREEMENT.

Customer's Authorized Signature _____
Printed Name _____ **Title** _____ **Date** _____



Lease Schedule ("Schedule") - Blended (SER-800)

Canon Solutions America, Inc. ("CSA")
One Canon Park, Melville, NY 11747
(800)-613-2228

Customer: CITY OF IMPERIAL
Agreement #: MA22995

CFS App #:
Transaction #: S1250654

Salesperson: D Andrew Leptich
Order Date: 02/02/22

Billing Information Customer Account: 1461524
Company: CITY OF IMPERIAL
DBA:
Address: 420 SOUTH IMPERIAL AVENUE
Address 2:
City: IMPERIAL County: IMPERIAL
State: CA Zip: 92251 Phone #: 760.355.3842
Contact: ALEJANDRO ESTRADA Fax #:
Email: AESTRADA@CITYOFIMPERIAL.ORG

Table with columns: Payment Information, Equipment Maintenance Information, Other Transaction Details. Includes rows for Lease Term (60 Months), Total (\$324.00), Due at Signing, and Excess Per Image Charge(s).

Table with columns: Item Code, Listed Items Description, Qty, Ship To & Maintenance Billing Information. Lists items like ICXLBP1538C, PAPER FEEDER PF-D1, and shipping details to 420 S IMPERIAL AVE.

Additional Requirements:
Consumables: Toner Only Auto-Toner Fulfillment**
Meter Method: imageWare Remote
For CSA USE ONLY:
Config: A | 64166779

OC: COUNTY OF DUPAGE CONTRACT FI-R-0251-18
THIS SCHEDULE IS ENTERED INTO PURSUANT TO, AND INCORPORATES THE TERMS OF, THE MASTER SALES AND SERVICES AGREEMENT REFERENCED AS THE AGREEMENT # ABOVE ("AGREEMENT"), INCLUDING THE MASTER LEASE TERMS SET FORTH AS RIDER G THERETO WHICH SHALL CONTROL (THE "LEASE TERMS").

Customer Authorized Signature: Printed Name: Title: Date:

ACCEPTANCE CERTIFICATE

To: CSA and Lessor: Customer certifies that (a) the Listed Items referred to in the above Schedule have been received, (b) installation has been completed, (c) the Listed Items have been examined by Customer and are in good operating order and condition and are, in all respects, satisfactory to the Customer, and (d) the Listed Items are irrevocably accepted by the Customer for all purposes under the Agreement.

Authorized Signature: Printed Name: Title: Date:

For Internal Purposes Only:
CFS Authorized Signature: Printed Name: Title: Date:



Customer: CITY OF IMPERIAL

Agreement #: MA22995

Order Date: 02/02/22 Salesperson: D Andrew Leptich

Device Excluded from Maintenance		Covered Images Included in Payment	Excess Per Image Charge(s)
Item Code	Listed Items Description	Qty	Ship To & Maintenance Billing Information
5517C003	IMAGEPROGRAF TZ-30000 MFP Z36 - CSA	1	Shipping: 420 S IMPERIAL AVE Delivery Date: 02/04/22
1972V064	ESP NEXT GEN PCS POWER FILTER (120V/15A) XG-PCS-15D	1	Address 2:
3954V773	CSA IMAGEPROGRAF TZ-30000 MFP Z36 INSTALL PAK (INSIDE ESS SERVICE TERRITORY ONLY)	1	City: IMPERIAL County: IMPERIAL State: CA Zip: 92251-1637
1708BB31	CUSA TZ-30000 4 YEAR + 9 MONTH EXTENDED SERVICE ECAREPAK (INSIDE ESS SERVICE TERRITORY ONLY)	1	Contact: ALEJANDRO ESTRADA Ph #: 760.355.3842 Email: AESTRADA@CITYOFIMPERIAL.ORG
			Mtr Contact: Ph #: Email:
			IT Contact: ALEJANDRO ESTRADA Ph #: 760.355.3842 Email: AESTRADA@CITYOFIMPERIAL.ORG
			Billing:
			Address 2:
			City: County: State: Zip:
			Contact: Ph #: Email:
			Elevator: No Loading Dock: No # of Steps: 0 Hrs of Operation: 9-5
			For CSA USE ONLY:
			Config: B - 1 64166780

Device Excluded from Maintenance		Covered Images Included in Payment	Excess Per Image Charge(s)
Item Code	Listed Items Description	Qty	Ship To & Maintenance Billing Information
			Shipping: Delivery Date:
			Address 2:
			City: County: State: Zip:
			Contact: Ph #: Email:
			Mtr Contact: Ph #: Email:
			IT Contact: Ph #: Email:
			Billing:
			Address 2:
			City: County: State: Zip:
			Contact: Ph #: Email:
			Elevator: Loading Dock: # of Steps: Hrs of Operation:
			For CSA USE ONLY:



Canon Solutions America, Inc. ("CSA")
One Canon Park, Melville, NY 11747
(800)-613-2228

Return Schedule, Rider B of Agreement

Customer: CITY OF IMPERIAL

Salesperson: D Andrew Leptich

Agreement #: MA22995

Transaction #: S1250654

Order date: 02/02/22

Customer ("You") Customer Account: 1461524 Service Requested: Trade In
Company: CITY OF IMPERIAL
Address: 420 SOUTH IMPERIAL AVENUE
City: IMPERIAL County: IMPERIAL
State: CA Zip: 92251 Phone: 760.355.3842
Contact name: ALEJANDRO ESTRADA
Email: AESTRADA@CITYOFIMPERIAL.ORG
Alternate Contact:
Alternate Phone:

If "Buyout Reimbursement" is selected above, the following MUST be completed:

\$ To be paid upon delivery / acceptance pursuant to Rider B, Section 1.
Payable to: Reason for check issuance:

If transaction includes a Lease Upgrade or Buyout the following MUST be completed:

Select one:
[] Not Applicable: No Equipment pick up required
[] CSA will pick up the Equipment
[] Return Equipment to CFS
[] Return Equipment to CSA Original Order Date
[] You will return Equipment to leasing company according to the terms and conditions of your lease agreement
[] You will retain the equipment.
Will retained equipment remain under a CSA Maintenance Agreement?
[] No
[] Yes: SELECT ONE: under an Existing Contract [] Or New Contract []

Trade in Equipment Condition: As-Is Condition

Equipment for Trade-In, Upgrade, or Return

If transaction includes a Lease return the following MUST be completed:

Table with 8 columns: Return code, Item Code, Description, Serial #, Equipment Location, Contact Name & Phone, Email, Alt pick up date. Row 1: TRD, 6471B002, IPF765, AAGP2592, 420 S IMPERIAL AVE IMPERIAL, CA 92251-1637, ALEJANDRO ESTRADA 760.355.3842, AESTRADA@CITYOFIMPERIAL.ORG

Pick Up /Return Information:

[] Same Date as Delivery of Listed Items Specified on the Agreement
[] Other Specified Date: / / (but no longer than 30 days after delivery of Listed Items under Agreement)

Contact Name: ALEJANDRO ESTRADA Phone: 760.355.3842 Email: AESTRADA@CITYOFIMPERIAL.ORG

Hours of Operation: 9-5 Number of Steps: 0 Elevator: No Loading Dock: No

Special Instructions:

THIS RETURN SCHEDULE IS ENTERED INTO PURSUANT TO, AND INCORPORATES ALL OF THE TERMS OF, THE MASTER SALES AND SERVICES AGREEMENT REFERENCED AS THE AGREEMENT # ABOVE AND THE APPLICABLE RIDER(S) ("AGREEMENT"). BY YOUR SIGNATURE BELOW, YOU AGREE TO TERMS AS SPECIFIED ABOVE, SUBJECT TO THE TERMS AND CONDITIONS OF THE AGREEMENT. CUSTOMER REPRESENTS THAT EXECUTION OF THIS SCHEDULE HAS BEEN DULY AUTHORIZED. YOU REPRESENT THAT YOU ARE AUTHORIZED TO EXECUTE THIS SCHEDULE ON CUSTOMER'S BEHALF. STANDARD TERMS AND CONDITIONS INCORPORATED HEREIN ARE AVAILABLE AT ESS.CSA.CANON.COM/CUSTOMERDOCUMENTS, AND SHALL APPLY TO THE EXTENT NOT MODIFIED BY THE AGREEMENT. YOU ACKNOWLEDGE RECEIPT OF A COPY OF THIS RETURN SCHEDULE.

Customer's Authorized Signature
Printed Name Title Date

Canon

The Fastest imagePROGRAF. Ever.

Up to 4 D Prints/Minute*
Up to 244 D Prints/Hour**

Integrated 100-Print
Capacity Top Stacker

Dual-Roll Intelligent Media-Handling System
that Detects Media Type, Width, and Length

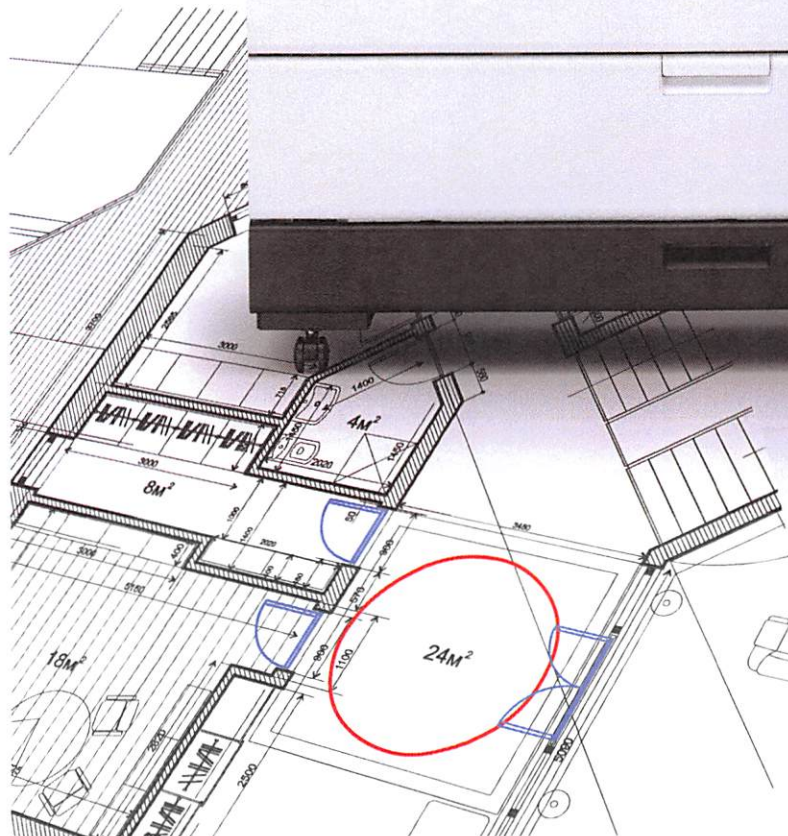
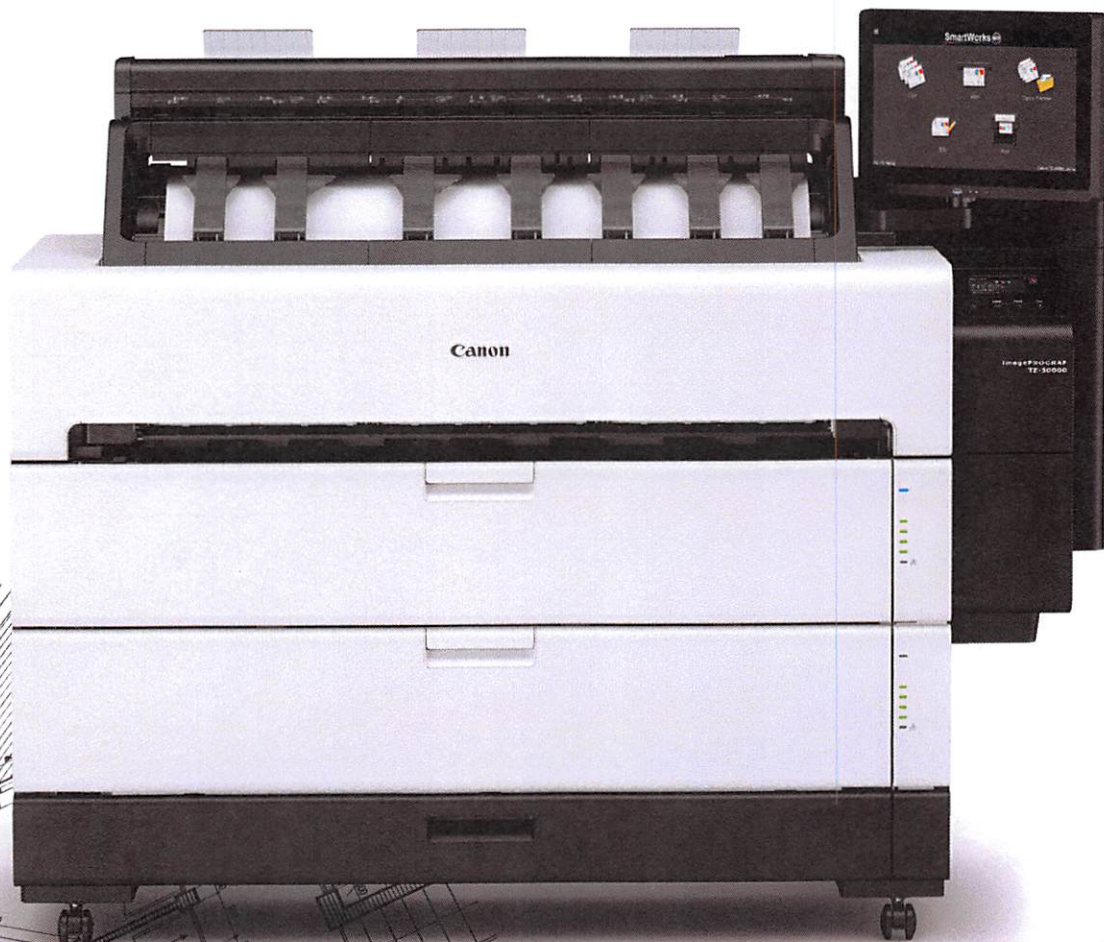

**imagePROGRAF
TZ-30000 MFP Z36**

PRINTER SPECIFICATIONS (see usa.canon.com for full printer specs)

Print Head PF-06
Number of Nozzles Matte Black: 5,120 Nozzles Other Colors: 2,560 Nozzles per Color
Droplet Size 5 Picoliter
Ink Type Pigment: Matte Black (MBK), Cyan (C), Magenta (M), Yellow (Y), Black (BK)
Ink Tank Shipped with Printer: 330ml MBK, 160ml BK,C,Y,M Replacement: PFI-340 (330 ml), PFI-740 (700 ml)
Printer RAM 128 GB (Virtual), 2 GB (Physical)
Hard Drive 500 GB
Media Feed Roll Feed: Two Rolls, Front Loading Cut Sheet: Front Loading
Media Width Roll Feed: 8" - 36" (203.2 mm - 914.4 mm) Cut Sheet: 8" - 36" (203.2 mm - 914.4 mm)
Media Cutter Durable Dual-Blade Rotary Cutter
Media Thickness 0.07 mm - 0.8 mm
Media Core Sizes 2" and 3" Core Adapters Included
Maximum Roll Outer Diameter 6.9" or Less
Media Output Front Output: Basket Top Output: Top Delivery Tray
Printing Software Utilities Accounting Manager, Canon Print Service, Device Management Console, Direct Print Plus, Printer Driver Extra Kit, Free Layout Plus, Media Configuration Tool, PosterArtist Lite for Windows, PosterArtist (optional purchase), CPP Publisher Select, Canon Printer Driver, CPP Driver Select, Optimized Driver for AutoCAD
Operating System Windows 7 (32/64-bit), Windows 8.1 (32/64-bit), Windows 10 (32/64-bit), Windows Server 2008 R2 (32/64 bit), Windows Server 2012 (64-bit), Windows Server 2016 (64-bit), Macintosh OS 10.12.6 and later
Print Language Printer: SGRRaster, HP-GL/2, HP RTL, PDF, JPEG
Interface USB B Port Type: Built-in (Hi-speed USB) Mode: Full Speed (12-Mbit/sec.), High Speed (480-Mbit/sec.), Bulk Transfer Connector Type: Series B (4 Pins)
USB A Port: USB Memory (Direct Print)
Gigabit Ethernet Type: Built-in Standard: IEEE 802.3u 100Base-TX/Auto-Negotiation IEEE 802.3ab 1000Base-T/Auto-Negotiation IEEE 802.3x Full Duplex Protocol: SNMP, HTTP, TCP/IP (IPv4/IPv6), FTP
Wireless LAN [■] Standard: IEEE802.11n/IEEE802.11g/IEEE802.11b Security: WEP (64/128-bit) WPA-PSK (TKIP/AES) WPA2-PSK (TKIP/AES)

Power Supply AC 100 - 240 V (50 - 60 Hz)
Power Consumption Maximum: 68 W or Less Standby: 3.6 W or Less Power Off: 0.3 W or Less
Certifications International ENERGY STAR [®] Program (WW), TUV, CB, EPEAT
Operational Environment Temperature: 59° F - 86° F (15° C - 30° C) Relative Humidity: 10 - 80% (No Condensation)
Printer Dimensions (H x W x D) and Weight 51" x 63" x 38; 478 lb. (Approx.)
Package Dimensions (H x W x D) and Weight TZ-30000: 54" x 67" x 37"; 604 lb. (Approx.) Z36 Scanner: 45" x 17" x 15"; 46 lb. (Approx.)
Options • 2"/3" Roll Holder Set (RH2-34) • PosterArtist
User-Replaceable Items • Ink Tank (PFI-340/PFI-740) • Print Head (PF-06) • Maintenance Cartridge (MC-30)
What's In The Box Printer, Top Output Stacker, Basket, 2"/3" Core Media Spool (Adapters Included), Power Cord, Tools and Screws, Print Head, Maintenance Cartridge (Installed), 5 Ink Tanks (330 ml MBK, 160 ml BK/C/M/Y), Ethernet Card (built-in), USB 2.0 High-speed Interface, USB Connection Sheet, iWR Service Terms Leaflet, User Manual, Quick Setup Guide, User Software CD for Windows (Printer Drive Utilities), PosterArtist Lite CD, User Registration Card, Warranty Statement

Z36 SCANNER SPECIFICATIONS

Scan Speed[■] • 24-bit Color @ 200 dpi: 3" (Per Second) • 8-bit Grayscale and Monochrome @ 200 dpi: 13" (Per Second)
Copy Speed 24-bit Color @ 200 dpi: 6" (Per Second)
Scan Modes • 16.7 Million Color RGB (24-bit) • 256-level Grayscale (8-bit) • Black and White (1-bit)
Color Space sRGB
Maximum Resolution 1200 dpi (Optical)
Scan Accuracy[▲] +/- 0.1% : +/- 1 pixel
Maximum Scan Width 36"
Maximum Media Width 38"
Maximum Scan Length 315" (JPEG/PDF); 598" (TIFF)
Maximum Media Thickness 0.003" - 0.04" (0.07 mm - 1.0 mm)
Media Feed System Adaptive CIS media focus management and media guide mechanism; intuitive face-up, front-loading, and front/rear-exit media path; automatic media size detection with optical media sensors

Digital Imaging Technology Contact Image Sensor (CIS) Technology (SingleSensor Assembly) • 24-bit RGB • 16-bit grayscale image capture • Panchromatic monochrome and black and white • Bi-directional extra long-life LED light system for optimum object illumination and instant-on scanning capability
Digital Image Processing • 2D Intelligent Adaptive Thresholding (IAT) (1-bit mode) • Fixed Threshold Black and White
User Status and One-Touch Operation Right-side mounted control panel, walk-up operation and user selection of stop, forward and rewind, scan, copy, or copy and archive
Included Software SmartWorks MFP Scan-to-Copy/File/Email with Real-time Image Viewer, supports TIFF, JPEG, TIF, G4, and PDF
Operating System Windows 10 LTSC
Scanner Interface Kit Superspeed USB 3.0 (PC Connector Compatible with USB 2.0 and USB 3.0 sockets)
Operating Environments 10°C - 35°C, 10 - 90% RH, Non-condensing
External Power Supply 100 - 240 VAC Autosenising +/- 10%, 50 - 60 Hz
Scanner Power Consumption • Sleep: 0.2 W • Idle: 12.4 W • Scanning Color/Grayscale at 200 dpi: 22.7 W/23.3 W
Compliances ENERGY STAR [®] , CB(62368-1), CE, FCC(EMC), Cu/UL, CCC, NOM-019, EAC, C-TICK, VCCI, BIS, EMC +LOA, UL AR, WEEE, REACH, RoHS, EU - Tier 3 of Lot 6

Scanner Dimensions (H x W x D) 6.1" x 41.6" x 9.9"
Scanner Weight 17 lb. 3 oz. (Approx.)
Scanner Package Dimensions (H x W x D) and Weight (With Stand, Pallet, and Scanner) 45" x 17" x 15"; 46 lb. (Approx.)
What's In The Box? • Z36 Scanner with Power Cord, USB 3.0 Cable (2 m) • 15.6" System Controller • 3:1 Trident Power Cord • Power Supply • Mount for Printer and System Controller • (2) Paper Edge Guides • (3) Document Return Guides • Calibration Target • Assembly and Startup Guide
* 14 seconds for an ANSI D print and 4 ANSI D prints/minute speed measured after first print in Fast Q5 mode, using plain paper.
** All speeds measured using plain paper, Fast Q5 mode. The 244 ANSI D prints/hour is measured from when the first print begins printing.
■ Wireless printing requires a working network with wireless 802.11b/g or 802.11n capability. Wireless performance may vary based on terrain and distance between the printer and wireless network clients.
■ The scan rate is proportional across the full range of resolutions supported by the scanner. Actual scan times will depend on the host system performance. Quoted top speeds may be limited by the effective bandwidth of the USB 2 and is not guaranteed for all media types.
▲ The quoted scan accuracy may vary depending on the operating environment and the thickness of the media
Note: The imagePROGRAF TZ Series MFP Z36 systems contain multiple components, some of which are manufactured by third parties. To the extent that such third-party offerings come with limited warranties, such limited warranties are hereby passed to the purchaser, and Canon shall have no obligation or any liability with respect to such third-party offerings.

usa.canon.com/imagePROGRAF



Canon and imagePROGRAF are registered trademarks of Canon Inc. in the United States and may also be registered trademarks or trademarks in other countries. All other referenced product names and marks are trademarks of their respective owners. Specifications and availability subject to change without notice. Not responsible for typographical errors.
©2021 Canon U.S.A., Inc. All rights reserved.
0321R1-TZ30000MFPSS-PDF-IH

