

CITY OF IMPERIAL

ATEN BLVD CLASS II BIKE LANE

FROM VILORE WAY TO AUSTIN ROAD

CML 5134(026)

GENERAL NOTES

- CITY ENCROACHMENT PERMIT CONDITIONS AND PROVISIONS SHALL TAKE PRECEDENCE OVER THE APPROVED PLANS AND SPECIFICATIONS FOR ANY CONFLICTS.
- THE STRUCTURAL SECTION SHALL BE IN ACCORDANCE WITH IMPERIAL CITY STANDARDS (OR COUNTY OF IMPERIAL, IF IN COUNTY OF IMPERIAL ROW) AND AS APPROVED BY THE PUBLIC SERVICES DIRECTOR (OR COUNTY OF IMPERIAL).
- APPROVAL OF THESE IMPROVEMENT PLANS AS SHOWN DOES NOT CONSTITUTE APPROVAL OF ANY CONSTRUCTION OUTSIDE THE PROJECT BOUNDARY.
- ALL UNDERGROUND UTILITIES WITHIN THE STREET RIGHT-OF-WAY SHALL BE CONSTRUCTED, CONNECTED AND TESTED PRIOR TO CONSTRUCTION OF BERM, CURB, CROSS-GUTTER AND PAVING.
- THE EXISTENCE AND LOCATION OF EXISTING UNDERGROUND FACILITIES SHOWN ON THESE PLANS WERE OBTAINED BY A SEARCH OF THE AVAILABLE RECORDS. TO THE BEST OF OUR KNOWLEDGE, THERE ARE NO OTHER EXISTING FACILITIES EXCEPT AS SHOWN ON THESE PLANS. HOWEVER, THE CONTRACTOR IS REQUIRED TO TAKE PRECAUTIONARY MEASURES TO PROTECT ANY EXISTING FACILITY SHOWN HEREON AND ANY OTHER WHICH IS NOT OF RECORD OR NOT SHOWN ON THESE PLANS.
- LOCATION AND ELEVATION OF IMPROVEMENTS TO BE MET BY WORK TO BE DONE SHALL BE CONFIRMED BY FIELD MEASUREMENTS PRIOR TO CONSTRUCTION OF NEW WORK. CONTRACTOR WILL MAKE EXPLORATORY EXCAVATIONS AND LOCATE EXISTING UNDERGROUND FACILITIES SUFFICIENTLY AHEAD OF CONSTRUCTION TO PERMIT REVISIONS TO PLANS IF REVISIONS ARE NECESSARY BECAUSE OF ACTUAL LOCATION OF EXISTING FACILITIES.
- UTILITIES COORDINATION
NO LESS THAN 3 WORKING DAYS PRIOR TO ANY EXCAVATION OR TRENCHING, EACH CONTRACTOR DOING SUCH WORK SHALL CONTACT THE FOLLOWING AGENCIES SO THAT EXISTING UNDERGROUND UTILITIES MAY BE LOCATED. THE AGENCY MAY REQUIRE AN INSPECTOR TO BE PRESENT.
A. CITY OF IMPERIAL (760) 355-1152
B. IMPERIAL IRRIGATION DISTRICT (POWER) (760) 482-3408
C. IMPERIAL IRRIGATION DISTRICT (WATER) (760) 339-9507
D. AT&T (800) 337-3358
E. SOUTHERN CA GAS CO. (760) 370-5812
F. SPECTRUM (760) 335-4818

- NO REVISIONS OF ANY KIND SHALL BE MADE TO THESE PLANS WITHOUT THE PRIOR WRITTEN APPROVAL OF BOTH THE CITY ENGINEER (OR HIS REPRESENTATIVE) AND THE ENGINEER OF RECORD. A REPRODUCIBLE AS-BUILT PLAN SET WILL BE PROVIDED TO THE ID AND PUBLIC WORKS DEPARTMENT AS A CONDITION OF SUBSTANTIAL CONSTRUCTION COMPLETION AND PRIOR TO ACCEPTANCE.
- ALL WORK AND MATERIAL SHALL CONFORM TO THESE PLANS AND SPECIFICATIONS. THE CITY OF IMPERIAL DEPARTMENT OF COMMUNITY DEVELOPMENT STANDARDS AND ID ENCROACHMENT PERMIT CONDITIONS (ID STANDARDS WITHIN ID RIGHT OF WAY), ALL WORK SHOWN OR INDICATED BY THESE PLANS SHALL BE COMPLETED IN ACCORDANCE WITH THE STANDARDS, POLICIES AND REGULATIONS OF THE CITY OF IMPERIAL, WHERE, OR IF, CONFLICTS OCCUR, THEN THE MOST STRINGENT REQUIREMENTS SHALL GOVERN.
- UNLESS SPECIFICALLY INDICATED OTHERWISE METHODS EMPLOYED AND MATERIAL USED IN THE CONSTRUCTION OF ALL OFFSITE IMPROVEMENTS SHALL CONFORM TO THE APPLICABLE PROVISIONS OF THE "STATE OF CALIFORNIA, DEPARTMENT OF TRANSPORTATION STANDARD SPECIFICATIONS, CURRENT EDITION. ALL WORK IS SUBJECT TO INSPECTION AND APPROVAL AS REQUIRED.
- THE CONTRACTOR SHALL OBTAIN A GENERAL CONSTRUCTION ACTIVITY STORM WATER PERMIT OR PROCESS A CONSTRUCTION STORMWATER WAIVER FROM THE STATE WATER RESOURCES CONTROL BOARD DIVISION OF WATER QUALITY. IT SHALL BE THE CONTRACTOR'S RESPONSIBILITY TO IMPLEMENT THE APPROVED STORMWATER POLLUTION PREVENTION PLAN (SWPPP) AND EROSION CONTROL PLANS AND PROVIDE MONITORING AND INSPECTION SERVICES BY A QUALIFIED SWPPP PRACTITIONER.
- AS DETERMINED BY THE COUNTY OF IMPERIAL PUBLIC WORKS DIRECTOR/ROAD COMMISSIONER, THE CONTRACTOR IS RESPONSIBLE FOR A MINIMUM FOR ROAD IMPROVEMENTS TO CENTERLINE, AND MAY BE REQUIRED TO RECONSTRUCT EXISTING PAVEMENT, INCLUDING BASE, AND MATCHING OVERLAY REQUIRED TO MEET THE STRUCTURAL STANDARDS FOR THE CURRENT ASSIGNED TRAFFIC INDEX.
- EXISTING STORM DRAIN PIPES/CULVERTS WHETHER TO BE CONNECTED TO, EXTENDED, ADJUSTED, DRAINED TO, OR JUST IN PROJECT VICINITY SHALL BE REPAIRED AND/OR CLEANED TO MAKE THEN FUNCTIONAL AND ACCEPTABLE AS DIRECTED BY THE PUBLIC SERVICES DIRECTOR.
- TRAFFIC CONTROL SHALL BE IN ACCORDANCE WITH THE CALIFORNIA MANUAL ON UNIFORM TRAFFIC CONTROL DEVICES (CAMUTCD), LATEST EDITION OR AS DIRECTED BY THE CITY/COUNTY OF IMPERIAL.
- ANY EXISTING SURVEY MONUMENTS OR COUNTY RECOGNIZED BENCHMARKS SHALL BE PROTECTED BY THE CONTRACTOR. SHOULD ANY SUCH MONUMENTS OR BENCHMARKS BE REMOVED, DAMAGED, OBLITERATED OR ALTERED BY THE CONTRACTOR'S OPERATIONS, THE CONTRACTOR SHALL BE RESPONSIBLE FOR PROPER RESETTING OF THE SAME AS PER THE SUBDIVISION MAP ACT, THE PROFESSIONAL LAND SURVEYORS ACT AND TO THE SATISFACTION OF THE COUNTY SURVEYOR/DIRECTOR OF PUBLIC WORKS. SUCH POINTS SHALL BE REFERENCED AND REPLACED WITH APPROPRIATE MONUMENTATION BY A LICENSED LAND SURVEYOR OR A REGISTERED CIVIL ENGINEER AUTHORIZED TO PRACTICE LAND SURVEYING. A CORNER RECORD OR RECORD OF SURVEY AS APPROPRIATE SHALL BE FILED BY THE LICENSED LAND SURVEYOR OR REGISTERED CIVIL ENGINEER.
- DUST SHALL BE CONTROLLED BY THE CONTRACTOR IN ACCORDANCE WITH ALL IMPERIAL COUNTY AIR POLLUTION CONTROL DISTRICT (APCD) FUGITIVE DUST CONTROL RULES AND REGULATIONS AND SHALL COMPLY WITH THEIR PERMITTING REQUIREMENTS, IF APPLICABLE.
- THE NOTES LISTED ABOVE ARE MINIMUM LIST. THIS DOES NOT RELIEVE THE ENGINEER FROM COMPLETING ADDITIONAL NOTES THAT MAY BE REQUIRED FOR THE PROJECT.
- IT IS THE RESPONSIBILITY OF THE CONTRACTOR AND SUBCONTRACTOR(S) TO EXAMINE THE PROJECT SITE PRIOR TO THE OPENING OF PROPOSALS. THE CONTRACTOR SHALL BECOME FAMILIAR AS TO THE CONDITIONS UNDER WHICH THE WORK IS TO BE PERFORMED. IT IS EXPECTED THAT QUESTIONS RELEVANT TO THE WORK TO BE PERFORMED AT THE PROJECT WILL BE PRESENTED TO THE ENGINEER PRIOR TO THE BID OPENING. IF CONFLICTS OR AMBIGUITIES EXIST BETWEEN JOB SITE CONDITIONS AND THE PLANS AND SPECIFICATIONS NO ALLOWANCE WILL BE PROVIDED TO THE CONTRACTOR AND SUBCONTRACTORS FOR NEGLECTING TO PROPERLY EXAMINE THE PROJECT SITE DURING THE BIDDING PERIOD.
- THE CONTRACTOR SHALL LOCATE MEN'S AND WOMEN'S PORTABLE RESTROOM FACILITIES AT THE PROJECT SITE DURING THE CONSTRUCTION PERIOD. THE PORTABLE RESTROOMS SHALL BE CLEANED ON A WEEKLY BASIS.
- THE CONTRACTOR SHALL PROVIDE FOR INGRESS AND EGRESS FOR PRIVATE PROPERTY ADJACENT TO THE WORK THROUGHOUT THE PERIOD OF CONSTRUCTION.

SHEET INDEX

SHEET NUMBER	DESCRIPTION
1	TITLE SHEET
2	STRIPING AND SIGNAGE PLAN
3	STRIPING PLAN
4	STRIPING PLAN
5	EROSION CONTROL PLAN

LEGEND

ITEM NO.	ITEM	SYMBOL	ITEM NO.	ITEM	SYMBOL
1.	CONSTRUCTION LIMITS	---	17.	STREET LIGHT	☼
2.	EXISTING ID ROW	---	18.	FIRE HYDRANT	⊙
3.	EXISTING ROAD ROW	---	19.	CHAIN LINK FENCE	⊗
4.	ID ENCROACHMENT LINE	---	20.	EXISTING POWER POLE	⊙
5.	EXISTING A.C. PAVEMENT	▨	21.	WATER VALVE	⊙
6.	NEW A.C. PAVEMENT	▨	22.	MANHOLE	⊙
7.	NEW A.C. PAVEMENT OVERLAY	▨	23.	WATER METER	⊙
8.	EXISTING P.C.C. SIDEWALK AND CURB AND GUTTER	▨	24.	SIGN WITH POST	⊙
9.	NEW P.C.C. SIDEWALK AND CURB AND GUTTER	▨	25.	MONUMENT	⊙
10.	REMOVE A.C. PAVEMENT AREA	▨	26.	GAS METER	⊙
11.	EXISTING 8" WATER LINE	---(8"W)---	27.	MAIL BOX	⊙
12.	EXISTING 12" SEWER LINE	---(12"SS)---	28.	TREE	⊙
13.	EXISTING OVERHEAD ELECTRICAL	---(OHE)---	29.	BACKFLOW PREVENTOR	⊙
14.	EXISTING GAS PIPELINE	---(GAS)---			
15.	EXISTING CABLE TV LINE	---(CATV)---			
16.	ROAD CENTERLINE	---			

ABBREVIATIONS

%	PERCENT	LP	UP OF CURB IN DRIVEWAYS
AGG.	AGGREGATE	LP	LOW POINT
APP.	APPROXIMATE	M.H.	MANHOLE
A.C.P.	ASBESTOS CEMENT PIPE	MAX.	MAXIMUM
A.C.	ASPHALT CONCRETE	M.J.	MECHANICAL JOINT
AWWA	AMERICAN WATER WORKS ASSOCIATION	MIN.	MINIMUM
AZ.	AZMUTH	MISC.	MISCELLANEOUS
B.C.	BEGINNING OF CURVE RADIUS	N.T.S.	NOT TO SCALE
BLDG.	BUILDING	O.C.	ON CENTER
B.V.	BUTTERFLY VALVE	O.D.	OUTSIDE DIAMETER
C.H.	CHORD	O.H.E.	OVERHEAD ELECTRICAL LINE
C.I.	CAST IRON	P.C.C.	PORTLAND CEMENT CONCRETE
CIRC	CIRCUMFERENTIAL	P.E.	PLAIN END
CL	CENTERLINE	P.I.G.	POINT OF INTERSECTING GRADES
CLR	CLEAR	P.I.T.	POINT OF INTERSECTING TANGENTS
C.M.C.	CEMENT MORTAR COATED	P.P.	POWER POLE
C.M.L.	CEMENT MORTAR LINED	P.V.C.	POLY VINYL CHLORIDE
DIA.	DIAMETER	P/S	PRESTRESSING
D.I.	DUCTILE IRON	R.	RADIUS
DWG	DRAWING	R.C.	REINFORCED CONCRETE
D/W	DRIVEWAY	ROW	RIGHT-OF-WAY
Δ	DELTA	R/C	REINFORCED CONCRETE
E.C.	END OF CURVE RADIUS	SCH	SCHEDULE
EF	EACH FACE	SQ	SQUARE
EL	ELEVATION	S.	SLOPE
E.P.	EDGE OF PAVEMENT	S.S.	STAINLESS STEEL
EW	EACH WAY	STA	STATION
EXT'G	EXISTING	S/W	SIDEWALK
F.F.	FINISH FLOOR ELEVATION	T.	TANGENT
FG	FINISHED GRADE	TBD	TO BE DETERMINED
F	FLOWLINE	T.C.	TOP OF CURB OR TOP OF CONCRETE
FL	FLANGED	TMH	TOP OF MANHOLE
F.S.	FINISH SURFACE	TOF	TOP OF FLOOR
GALV	GALVANIZED	TOW	TOP OF WALL
H.B.	HOSE BIB	T.P.	TOP OF PAVEMENT
HDPE	HIGH DENSITY POLYETHYLENE	TYP.	TYPICAL
HPUD	HEBER PUBLIC UTILITY DISTRICT	UNO	UNLESS NOTED OTHERWISE
HW	HIGH WATER	VCP	VITRIFIED CLAY PIPE
I.D.	INSIDE DIAMETER	VERT	VERTICAL
I.L.D.	IMPERIAL IRRIGATION DISTRICT		
IE	INVERT ELEVATION		
INV.	INVERT		
L	LENGTH		

VICINITY MAP

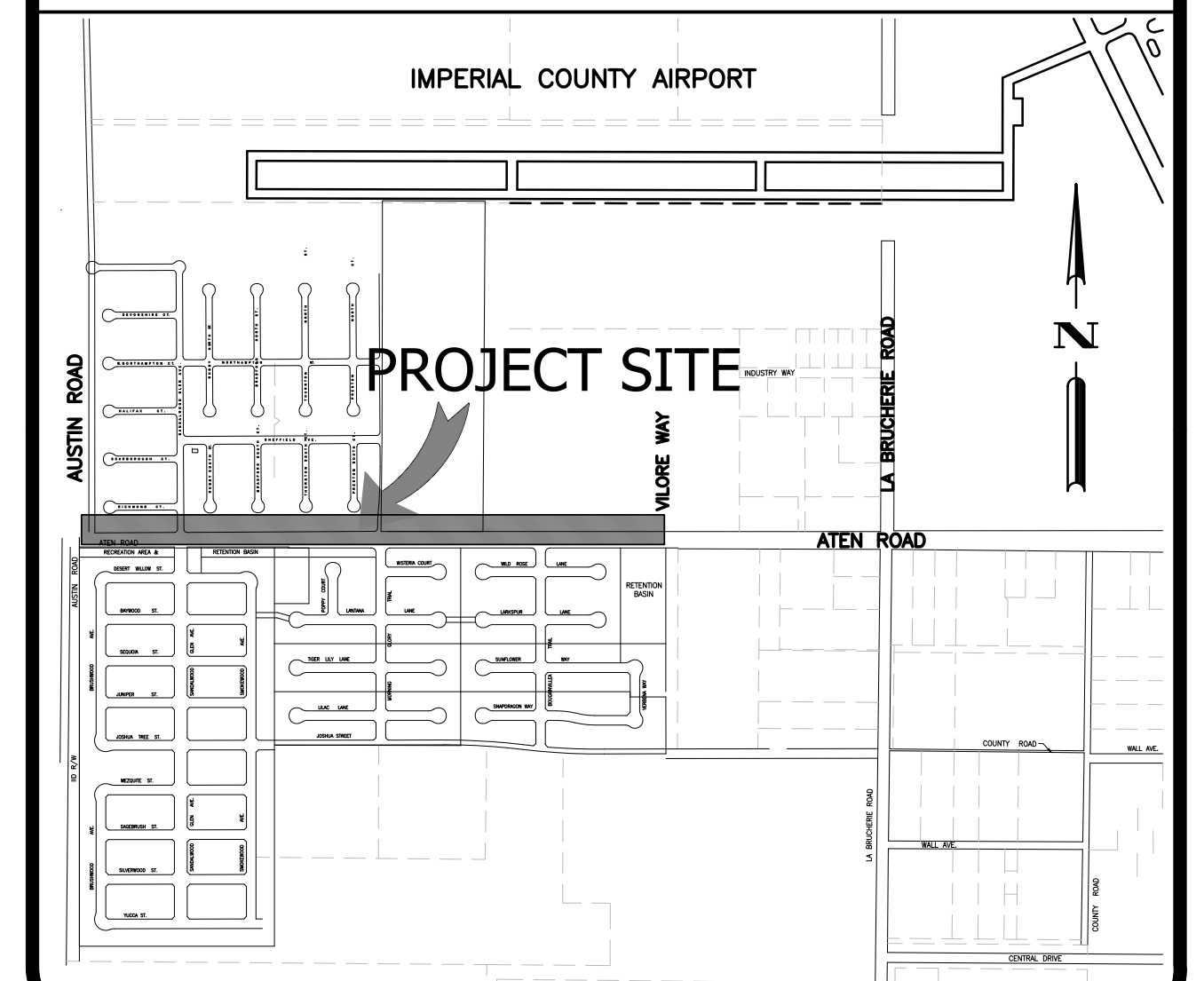

CITY COUNCIL

ROBERT AMPARANO	MAYOR
JAMES TUCKER	MAYOR PRO-TEM
KATHERINE BURNWORTH	COUNCIL MEMBER
STACY MENDOZA	COUNCIL MEMBER
IDA OBESO-MARTINEZ	COUNCIL MEMBER

CITY STAFF

DENNIS H. MORITA	CITY MANAGER
KRISTINA SHIELDS	CITY CLERK
DAVID DALE	PUBLIC SERVICES DIRECTOR
OTHON MORA	COMMUNITY DEVELOPMENT DIRECTOR
AARON REEL	POLICE CHIEF
DAVID LANTZER	FIRE CHIEF
KATHERINE TURNER	CITY ATTORNEY

PROJECT DESCRIPTION

THE PROJECT CONSISTS OF INSTALLING HIGH VISIBILITY CLASS II BIKE LANES ON BOTH SIDES OF ATEN BLVD BETWEEN VILORE WAY AND AUSTIN ROAD. ALL STRIPING IS TO BE INSTALLED USING THERMOPLASTIC IN ORDER TO INCREASE THE LIFE OF THE IMPROVEMENTS. TRAFFIC SIGNS WILL ALSO BE INSTALLED TO INCREASE MOTORIST AWARENESS AND FURTHER INCREASING BICYCLIST SAFETY.

DECLARATION OF RESPONSIBLE CHARGE

I HEREBY DECLARE THAT I AM THE ENGINEER OF THE WORK OF THIS PROJECT, THAT I HAVE EXERCISED RESPONSIBLE CHARGE OVER THE DESIGN OF THE PROJECT AS DEFINED IN SECTION OF 6703 OF THE BUSINESS AND PROFESSIONS CODE AND THAT THE DESIGN IS CONSISTENT WITH CURRENT STANDARDS. I UNDERSTAND THAT THE CHECK OF THE PROJECT DRAWINGS AND SPECIFICATIONS BY THE CITY OF IMPERIAL IS CONFINED TO REVIEW ONLY AND DOES NOT RELIEVE ME, AS ENGINEER OF WORK, OF MY RESPONSIBILITY FOR PROJECT DESIGN.

CARLOS CORRALES
LC ENGINEERING CONSULTANTS INC.
1065 STATE STREET
EL CENTRO, CALIFORNIA 92243
(760)353-8110

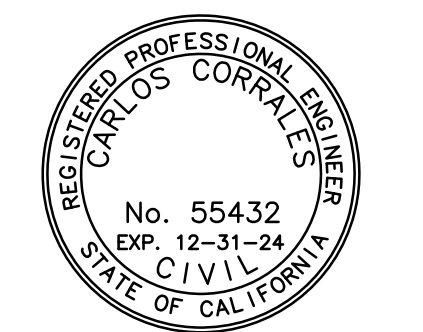

BY: *Carlos Corrales*
CARLOS CORRALES
R.C.E. No. 55,432

DATE: 07/03/24
EXPIRATION DATE: 12/31/24

DIG ALERT



CALL TOLL FREE
1-800-441-1133 OR 811
TWO FULL WORKING DAYS
BEFORE YOU DIG

DATE	BY	MARK	REVISIONS	APPR.	DATE
	ENGINEER				CITY

APPROVED BY DIRECTOR OF PUBLIC SERVICES

CITY OF IMPERIAL, CA.

BY: _____ DATE: _____

ENGINEER OF RECORD

PLANS PREPARED UNDER THE SUPERVISION OF

BY: *Carlos Corrales*
CARLOS CORRALES

DATE: 07/03/24

R.C.E. NO.: 55432

SEAL

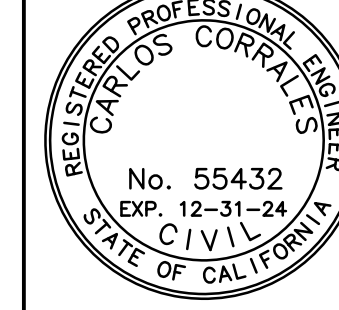

LC ENGINEERING CONSULTANTS INC.
CIVIL ENGINEERING • LAND SURVEYING • CONSTRUCTION MANAGEMENT SERVICES
1065 State Street
El Centro CA 92243
www.lcec-inc.com info@lcec-inc.com
tel: 760.353.8110 fax: 760.353.8146

DATE: 07/03/24 BENCHMARK: SEE SHEET NO. 1

CITY OF IMPERIAL

IMPROVEMENT PLANS
TITLE SHEET
ATEN BLVD CLASS II BIKE LANE
FROM VILORE WAY TO AUSTIN ROAD
CML 5134(026)

W.O.

SHEET

1 OF
5 SHEETS
JOB NO.

C23002-00

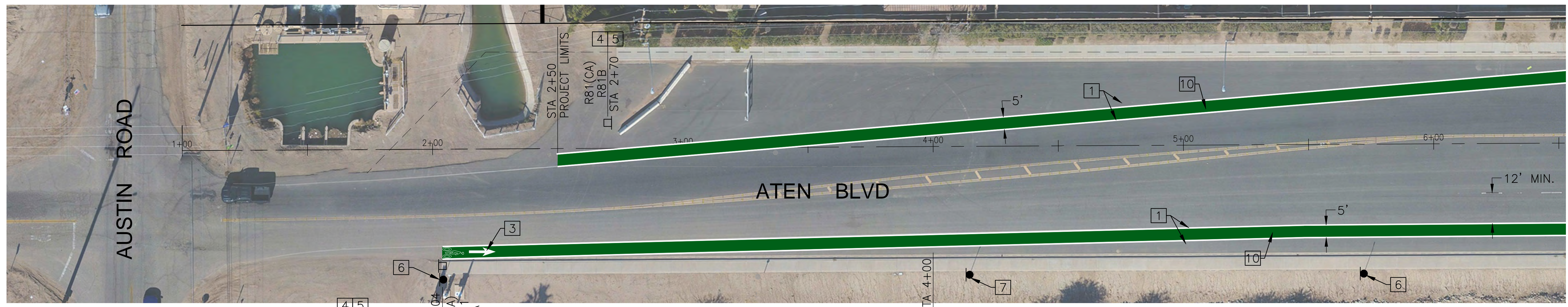
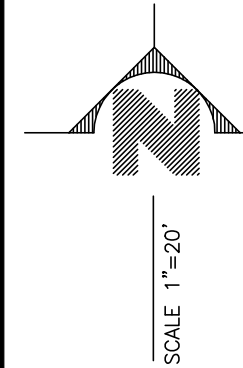

SEE BELOW LEFT MATCH LINE STA 6+50

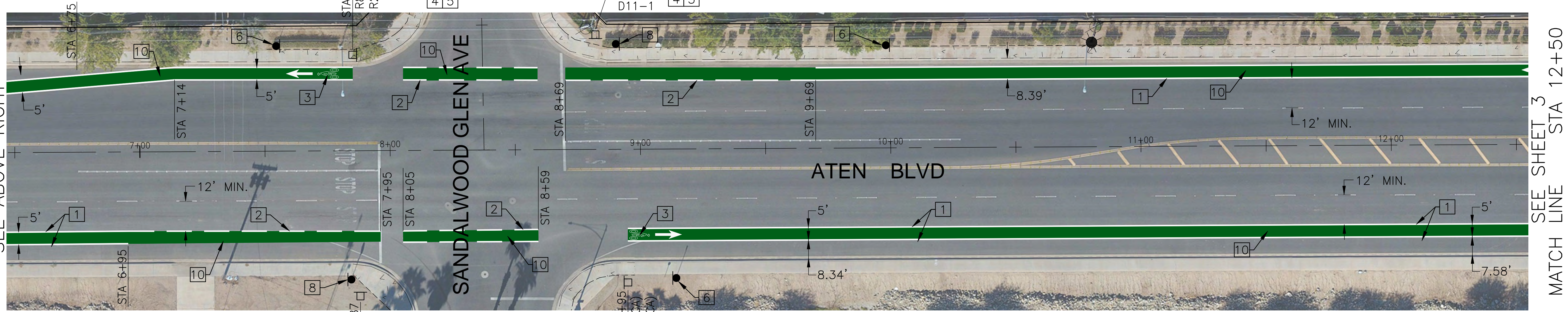
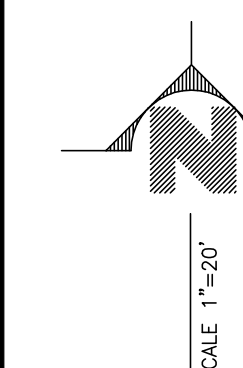

SEE ABOVE RIGHT MATCH LINE STA 6+50

SEE SHEET 3 MATCH LINE STA 12+50

NOTES:

1. THE CONTRACTOR IS RESPONSIBLE FOR TRAFFIC CONTROL DURING THE INSTALLATION, REMOVAL OR MODIFICATION OF ALL SIGNING AND STRIPING SHOWN ON THESE PLANS.
2. THE APPLICATION OF THE TRAFFIC CONTROL DEVICES AND THEIR PLACEMENT SHALL CONFORM TO THE CURRENT CALIFORNIA "MANUAL OF TRAFFIC CONTROLS FOR CONSTRUCTION AND MAINTENANCE WORK ZONES."
3. IN ADDITION TO THE GUIDELINES PROVIDED BY THE ABOVE REFERENCED MANUAL OF TRAFFIC CONTROLS FOR THE SELECTION OF THE MOST APPROPRIATE DEVICES AND THEIR PLACEMENT, THE TRAFFIC CONTROL DETAIL DESCRIBED IN SHEET NO. T-9 THROUGH T-17 OF THE CALIFORNIA STANDARD PLANS 2015 EDITION SHALL BE USED IN SITUATION REQUIRING LANE CLOSURES OR DETOURING THE PATH OF VEHICLES IN VARIOUS STAGES OF CONSTRUCTION.
4. CONTRACTOR SHALL REMOVE AND SALVAGE ALL EXISTING CONFLICTING SIGNS, PAVEMENT MARKERS AND HYDROBLAST ALL CONFLICTING EXISTING STRIPING AND PAVEMENT MARKINGS.
5. ALL TRAFFIC STRIPING, PAVEMENT MARKINGS AND TRAFFIC SIGNS SHALL BE INSTALLED BY THE CONTRACTOR AND CONFORM TO CALTRANS STANDARD PLANS AND STANDARD SPECIFICATIONS, DATED JANUARY 2015 AND THE CALIFORNIA MANUAL ON UNIFORM TRAFFIC CONTROL DEVICES DATED 2014. (REVISION 6).
6. NO STRIPING MAY BE DONE PRIOR TO FIELD INSPECTION AND APPROVAL BY THE ENGINEER IN THE FIELD. STRIPING SHALL NOT BE PLACED UNTIL SPOTTED. CONTRACTOR SHALL CONTACT THE PUBLIC WORKS ENGINEER DIVISION, TWO WORKING DAYS PRIOR TO STRIPING INSTALLATION TO SCHEDULE FOR INSPECTION.
7. TRAFFIC STRIPING AND PAVEMENT MARKINGS SHALL BE IN ACCORDANCE WITH CALTRANS STANDARD SPECIFICATIONS, DATED JANUARY 2015.
8. THE APPLICATION ON THERMOPLASTIC MATERIALS SHALL BE IN ACCORDANCE WITH CALTRANS STANDARD SPECIFICATIONS SECTION 84-2.04, DATED JANUARY 2015.
9. FOR NEW PROPOSED PARKING RESTRICTIONS, CONTRACTOR SHALL INSTALL RED CURB OR "NO STOPPING ANYTIME" SIGNS AS INDICATED ON PLANS 24-HOURS PRIOR TO MARK OUT OF PROPOSED STRIPING.

MUTCD SIGNS:

	R81 (CA)
	R26 (CA)
	D11-1
	R81A (CA)
	R81B (CA)

BICYCLE LANE MARKING PER CALTRANS STD PLANS.

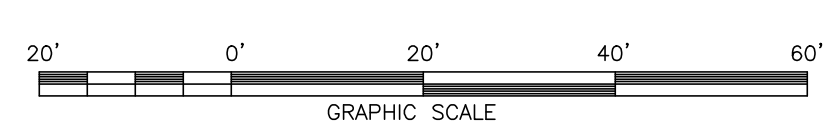

LEGEND:

	EXISTING STRIPING
	PROPOSED STRIPING
	PROPOSED SQUARE TUBE SIGN POLE
	EXISTING SIGN

STRIPING & SIGNAGE NOTES:

1. INSTALL THERMOPLASTIC 6-INCH WIDE SOLID WHITE LANE LINE.
2. INSTALL THERMOPLASTIC 6-INCH WIDE SKIP WHITE LANE LINE. PER CALTRANS STANDARD PLAN NO A20D DETAIL 39A.
3. INSTALL THERMOPLASTIC WHITE BIKE LANE ARROW PAVEMENT MARKINGS PER CALTRANS STANDARD PLAN NO. A24A AND INSTALL BIKE LANE SYMBOL PAVEMENT MARKINGS PER CALTRANS STANDARD PLAN NO. A24C.
4. FURNISH AND INSTALL 2" GALVANIZED SQUARE TUBING SIGN POLE.
5. FURNISH AND INSTALL SIGN AS INDICATED ON PLAN.
6. EXISTING "BIKE LINE NO PARKING" SIGN TO BE REMOVED.
7. EXISTING "SPEED LIMIT" SIGN TO REMAIN.
8. EXISTING "STOP" SIGN TO REMAIN.
9. EXISTING "STOP AHEAD" SIGN TO REMAIN.
10. INSTALL PREFORMED THERMOPLASTIC GREEN PAVEMENT MARKINGS 5' WIDE AS SHOWN ON PLANS.

DIG ALERT

CALL: TOLL FREE 1-800-422-4133 OR 811
TWO FULL WORKING DAYS BEFORE YOU DIG

DATE	BY	MARK	REVISIONS	APPR. DATE	CITY

APPROVED BY DIRECTOR OF PUBLIC SERVICES
CITY OF IMPERIAL, CA.
BY: _____ DATE: _____

ENGINEER OF RECORD
PLANS PREPARED UNDER THE SUPERVISION OF
BY: DATE: 07/03/24
CARLOS CORRALES
R.C.E. NO.: 55432



LC ENGINEERING CONSULTANTS INC.
CIVIL ENGINEERING • LAND SURVEYING • CONSTRUCTION MANAGEMENT SERVICES
1065 State Street
El Centro CA 92243
www.lcec-inc.com info@lcec-inc.com
tel: 951.333.8100 fax: 951.333.6198

DATE: 07/03/24 BENCHMARK: SEE SHEET NO. 1

CITY OF IMPERIAL
IMPROVEMENT PLANS
STRIPING & SIGNAGE PLAN
ATEN BLVD CLASS II BIKE LANE
FROM VILLORE WAY TO AUSTIN ROAD
CML 5134(026)

SHEET
2 OF
5 SHEETS
JOB NO.
C23002-00

L:\Projects\2023\C23002-00 (City of Imperial - Aten Blvd Class II Bike Lane)\Engineering\Improvements\CAD\C23002-00 - Striping Plans.dwg 07/03/2024 15:11

L:\Projects\2023\C23002-00 (City of Imperial - Aten Blvd Class II Bike Lane) \Engineering\Improvements\CAD\C23002-00 - Striping Plans.dwg 07/03/2024 1:51:11



NOTES:

1. THE CONTRACTOR IS RESPONSIBLE FOR TRAFFIC CONTROL DURING THE INSTALLATION, REMOVAL OR MODIFICATION OF ALL SIGNING AND STRIPING SHOWN ON THESE PLANS.
2. THE APPLICATION OF THE TRAFFIC CONTROL DEVICES AND THEIR PLACEMENT SHALL CONFORM TO THE CURRENT CALIFORNIA "MANUAL OF TRAFFIC CONTROLS FOR CONSTRUCTION AND MAINTENANCE WORK ZONES".
3. IN ADDITION TO THE GUIDELINES PROVIDED BY THE ABOVE REFERENCED MANUAL OF TRAFFIC CONTROLS FOR THE SELECTION OF THE MOST APPROPRIATE DEVICES AND THEIR PLACEMENT, THE TRAFFIC CONTROL DETAIL DESCRIBED IN SHEET NO. T-9 THROUGH T-17 OF THE CALIFORNIA STANDARD PLANS 2015 EDITION SHALL BE USED IN SITUATION REQUIRING LANE CLOSURES OR DETOURING THE PATH OF VEHICLES IN VARIOUS STAGES OF CONSTRUCTION.
4. CONTRACTOR SHALL REMOVE AND SALVAGE ALL EXISTING CONFLICTING SIGNS, PAVEMENT MARKERS AND HYDROBLAST ALL CONFLICTING EXISTING STRIPING AND PAVEMENT MARKINGS.
5. ALL TRAFFIC STRIPING, PAVEMENT MARKERS, PAVEMENT MARKINGS AND TRAFFIC SIGNS SHALL BE INSTALLED BY THE CONTRACTOR AND CONFORM TO CALTRANS STANDARD PLANS AND STANDARD SPECIFICATIONS, DATED JANUARY 2015 AND THE CALIFORNIA MANUAL ON UNIFORM TRAFFIC CONTROL DEVICES DATED 2014. (REVISION 6).
6. NO STRIPING MAY BE DONE PRIOR TO FIELD INSPECTION AND APPROVAL BY THE ENGINEER IN THE FIELD. STRIPING SHALL NOT BE PLACED UNTIL SPOTTED. CONTRACTOR SHALL CONTACT THE PUBLIC WORKS ENGINEER DIVISION, TWO WORKING DAYS PRIOR TO STRIPING INSTALLATION TO SCHEDULE FOR INSPECTION.
7. TRAFFIC STRIPING AND PAVEMENT MARKINGS SHALL BE IN ACCORDANCE WITH CALTRANS STANDARD SPECIFICATIONS, DATED JANUARY 2015.
8. THE APPLICATION ON THERMOPLASTIC MATERIALS SHALL BE IN ACCORDANCE WITH CALTRANS STANDARD SPECIFICATIONS SECTION 84-2.04, DATED JANUARY 2015.
9. FOR NEW PROPOSED PARKING RESTRICTIONS, CONTRACTOR SHALL INSTALL RED CURB OR "NO STOPPING ANYTIME" SIGNS AS INDICATED ON PLANS 24-HOURS PRIOR TO MARK OUT OF PROPOSED STRIPING.

MUTCD SIGNS:

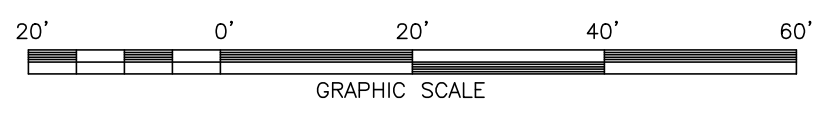
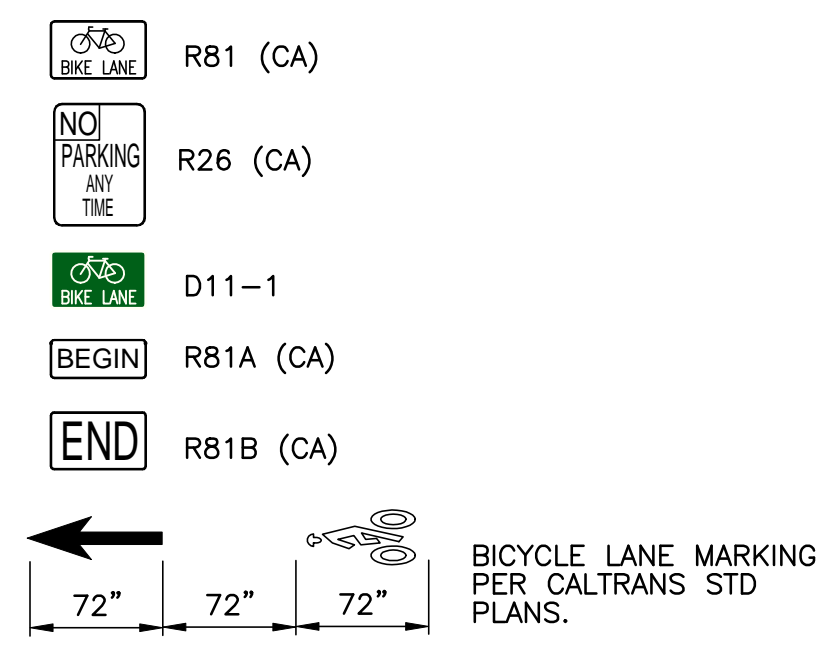

LEGEND:

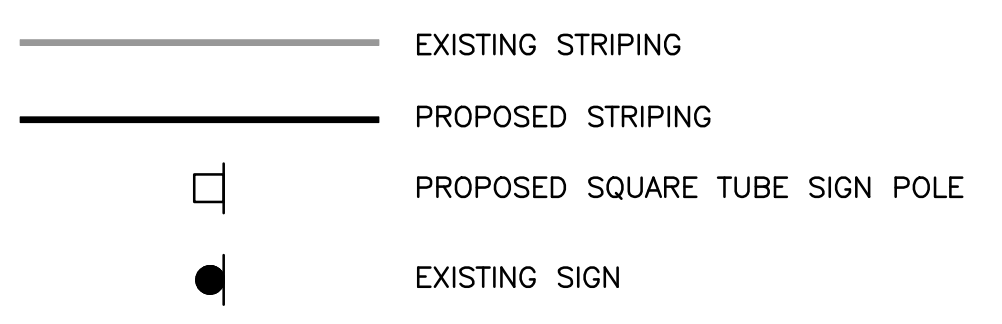

STRIPING & SIGNAGE NOTES:

1. INSTALL THERMOPLASTIC 6-INCH WIDE SOLID WHITE LANE LINE.
2. INSTALL THERMOPLASTIC 6-INCH WIDE SKIP WHITE LANE LINE. PER CALTRANS STANDARD PLAN NO A20D DETAIL 39A.
3. INSTALL THERMOPLASTIC WHITE BIKE LANE ARROW PAVEMENT MARKINGS PER CALTRANS STANDARD PLAN NO. A24A AND INSTALL BIKE LANE SYMBOL PAVEMENT MARKINGS PER CALTRANS STANDARD PLAN NO. A24C.
4. FURNISH AND INSTALL 2" GALVANIZED SQUARE TUBING SIGN POLE.
5. FURNISH AND INSTALL SIGN AS INDICATED ON PLAN.
6. EXISTING "BIKE LINE NO PARKING" SIGN TO BE REMOVED.
7. EXISTING "SPEED LIMIT" SIGN TO REMAIN.
8. EXISTING "STOP" SIGN TO REMAIN.
9. EXISTING "STOP AHEAD" SIGN TO REMAIN.
10. INSTALL PREFORMED THERMOPLASTIC GREEN PAVEMENT MARKINGS 5" WIDE AS SHOWN ON PLANS.

DIG ALERT

DATE	BY	MARK	APPR.	DATE
ENGINEER			CITY	
REVISIONS				

APPROVED BY DIRECTOR OF PUBLIC SERVICES
CITY OF IMPERIAL, CA.

BY: _____ DATE: _____

ENGINEER OF RECORD
PLANS PREPARED UNDER THE SUPERVISION OF

BY: *Carlos Corrales* DATE: 07/03/24
CARLOS CORRALES

R.C.E. NO.: 55432

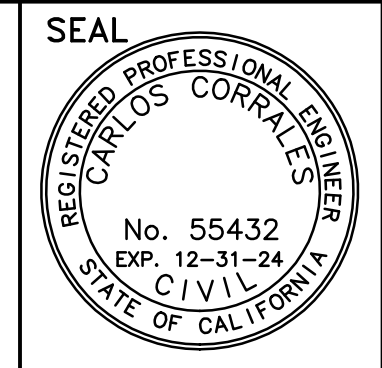

LC ENGINEERING CONSULTANTS INC.
CIVIL ENGINEERING • LAND SURVEYING • CONSTRUCTION MANAGEMENT SERVICES

1065 State Street
El Centro CA 92243

DATE: 07/03/24 BENCHMARK: SEE SHEET NO. 1

CITY OF IMPERIAL
IMPROVEMENT PLANS
STRIPING & SIGNAGE PLAN
ATEN BLVD CLASS II BIKE LANE
FROM VILORE WAY TO AUSTIN ROAD
CML 5134(026)

SHEET
3 OF
5 SHEETS
JOB NO.
C23002-00

L:\Projects\2023\C23002-00 (City of Imperial - Aten Blvd Class II Bike Lane)\Engineering\Improvements\CAD\C23002-00 - Striping Plans.dwg 07/03/2024 1:51:11

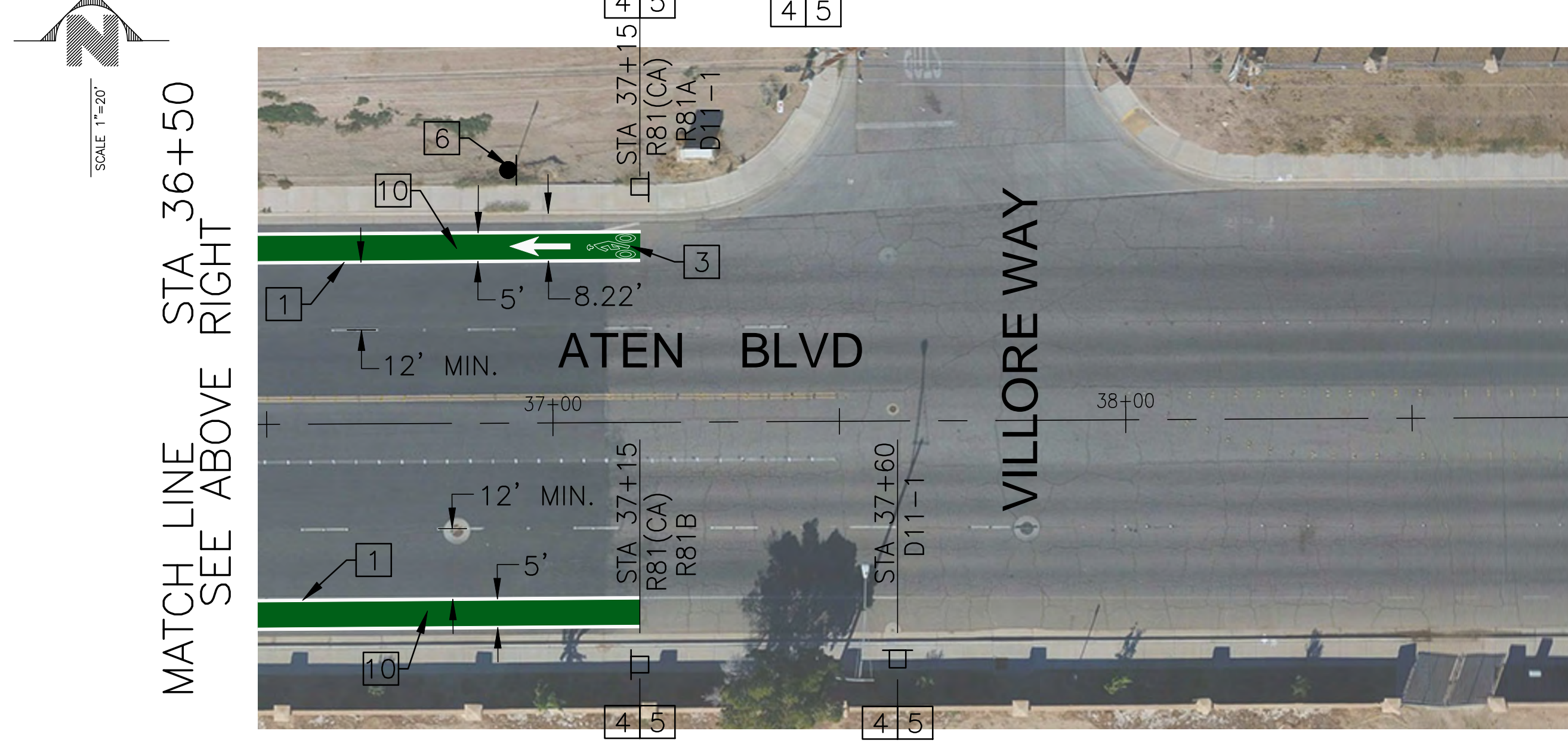
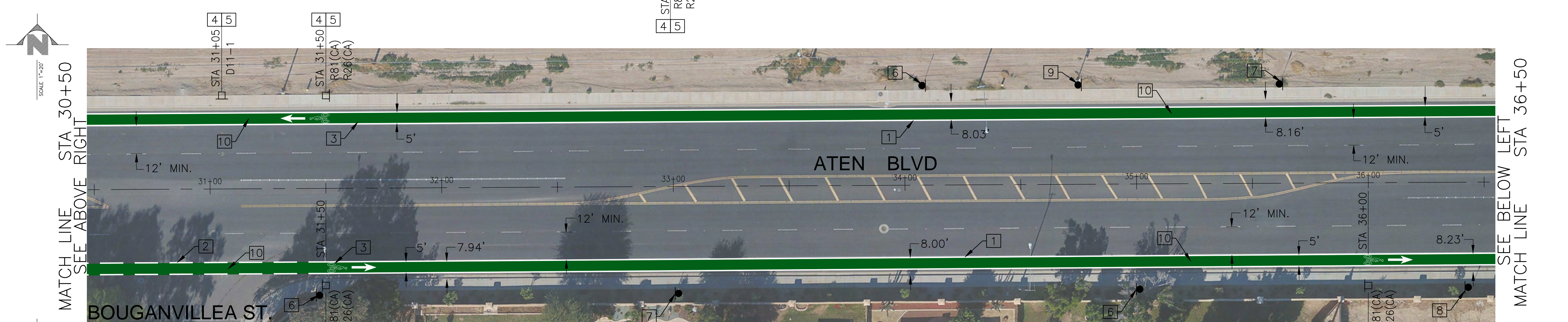
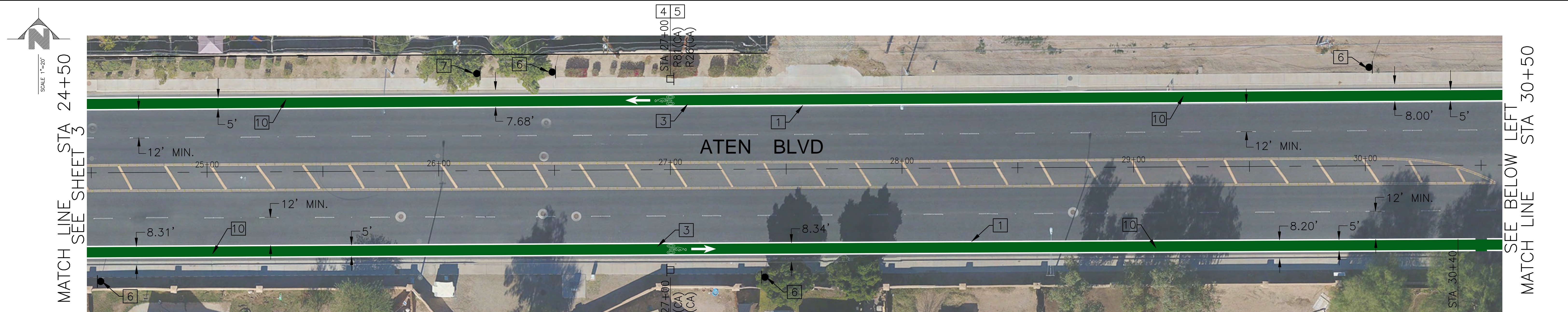

- NOTES:**
1. THE CONTRACTOR IS RESPONSIBLE FOR TRAFFIC CONTROL DURING THE INSTALLATION, REMOVAL OR MODIFICATION OF ALL SIGNING AND STRIPING SHOWN ON THESE PLANS.
 2. THE APPLICATION OF THE TRAFFIC CONTROL DEVICES AND THEIR PLACEMENT SHALL CONFORM TO THE CURRENT CALIFORNIA "MANUAL OF TRAFFIC CONTROLS FOR CONSTRUCTION AND MAINTENANCE WORK ZONES."
 3. IN ADDITION TO THE GUIDELINES PROVIDED BY THE ABOVE REFERENCED MANUAL OF TRAFFIC CONTROLS FOR THE SELECTION OF THE MOST APPROPRIATE DEVICES AND THEIR PLACEMENT, THE TRAFFIC CONTROL DETAIL DESCRIBED IN SHEET NO. T-9 THROUGH T-17 OF THE CALIFORNIA STANDARD PLANS 2015 EDITION SHALL BE USED IN SITUATION REQUIRING LANE CLOSURES OR DETOURING THE PATH OF VEHICLES IN VARIOUS STAGES OF CONSTRUCTION.
 4. CONTRACTOR SHALL REMOVE AND SALVAGE ALL EXISTING CONFLICTING SIGNS, PAVEMENT MARKERS AND HYDROBLAST ALL CONFLICTING EXISTING STRIPING AND PAVEMENT MARKINGS.
 5. ALL TRAFFIC STRIPING, PAVEMENT MARKINGS AND TRAFFIC SIGNS SHALL BE INSTALLED BY THE CONTRACTOR AND CONFORM TO CALTRANS STANDARD PLANS AND STANDARD SPECIFICATIONS, DATED JANUARY 2015 AND THE CALIFORNIA MANUAL ON UNIFORM TRAFFIC CONTROL DEVICES DATED 2014. (REVISION 6).
 6. NO STRIPING MAY BE DONE PRIOR TO FIELD INSPECTION AND APPROVAL BY THE ENGINEER IN THE FIELD. STRIPING SHALL NOT BE PLACED UNTIL SPOTTED. CONTRACTOR SHALL CONTACT THE PUBLIC WORKS ENGINEER DIVISION, TWO WORKING DAYS PRIOR TO STRIPING INSTALLATION TO SCHEDULE FOR INSPECTION.
 7. TRAFFIC STRIPING AND PAVEMENT MARKINGS SHALL BE IN ACCORDANCE WITH CALTRANS STANDARD SPECIFICATIONS, DATED JANUARY 2015.
 8. THE APPLICATION ON THERMOPLASTIC MATERIALS SHALL BE IN ACCORDANCE WITH CALTRANS STANDARD SPECIFICATIONS SECTION 84-2.04, DATED JANUARY 2015.
 9. FOR NEW PROPOSED PARKING RESTRICTIONS, CONTRACTOR SHALL INSTALL RED CURB OR "NO STOPPING ANYTIME" SIGNS AS INDICATED ON PLANS 24-HOURS PRIOR TO MARK OUT OF PROPOSED STRIPING.

MUTCD SIGNS:

- R81 (CA)
- R26 (CA)
- D11-1
- R81A (CA)
- R81B (CA)
- BICYCLE LANE MARKING PER CALTRANS STD PLANS.

LEGEND:

- EXISTING STRIPING
- PROPOSED STRIPING
- PROPOSED SQUARE TUBE SIGN POLE
- EXISTING SIGN

STRIPING & SIGNAGE NOTES:

1. INSTALL THERMOPLASTIC 6-INCH WIDE SOLID WHITE LANE LINE.
2. INSTALL THERMOPLASTIC 6-INCH WIDE SKIP WHITE LANE LINE. PER CALTRANS STANDARD PLAN NO A20D DETAIL 39A.
3. INSTALL THERMOPLASTIC WHITE BIKE LANE ARROW PAVEMENT MARKINGS PER CALTRANS STANDARD PLAN NO. A24A AND INSTALL BIKE LANE SYMBOL PAVEMENT MARKINGS PER CALTRANS STANDARD PLAN NO. A24C.
4. FURNISH AND INSTALL 2" GALVANIZED SQUARE TUBING SIGN POLE.
5. FURNISH AND INSTALL SIGN AS INDICATED ON PLAN.
6. EXISTING "BIKE LINE NO PARKING" SIGN TO BE REMOVED.
7. EXISTING "SPEED LIMIT" SIGN TO REMAIN.
8. EXISTING "STOP" SIGN TO REMAIN.
9. EXISTING "STOP AHEAD" SIGN TO REMAIN.
10. INSTALL PREFORMED THERMOPLASTIC GREEN PAVEMENT MARKINGS 5" WIDE AS SHOWN ON PLANS.

GRAPHIC SCALE: 0' 20' 40' 60'

<p>DIG ALERT</p> <p>CALL: TOLL FREE 1-800-422-4133 OR 811 TWO FULL WORKING DAYS BEFORE YOU DIG</p>	<p>APPROVED BY DIRECTOR OF PUBLIC SERVICES</p> <p>CITY OF IMPERIAL, CA.</p>	<p>ENGINEER OF RECORD</p> <p>PLANS PREPARED UNDER THE SUPERVISION OF</p> <p>BY: CARLOS CORRALES DATE: 07/03/24</p> <p>R.C.E. NO.: 55432</p>	<p>SEAL</p>	<p>LC ENGINEERING CONSULTANTS INC.</p> <p>CIVIL ENGINEERING • LAND SURVEYING • CONSTRUCTION MANAGEMENT SERVICES</p> <p>1065 State Street El Centro CA 92243</p> <p>www.lce-inc.com tel 760.353.8700 info@lce-inc.com fax 760.353.6108</p> <p>DATE: 07/03/24 BENCHMARK: SEE SHEET NO. 1</p>	<p>CITY OF IMPERIAL</p> <p>IMPROVEMENT PLANS</p> <p>STRIPING & SIGNAGE PLAN</p> <p>ATEN BLVD CLASS II BIKE LANE FROM VILLORE WAY TO AUSTIN ROAD CML 5134(026)</p> <p>W.O.</p>	<p>SHEET</p> <p>4 OF 5 SHEETS</p> <p>JOB NO. C23002-00</p>									
	<table border="1" style="width: 100%; border-collapse: collapse;"> <thead> <tr> <th>DATE</th> <th>BY</th> <th>MARK</th> <th>APPR.</th> <th>DATE</th> </tr> </thead> <tbody> <tr> <td> </td> <td> </td> <td> </td> <td> </td> <td> </td> </tr> </tbody> </table>	DATE	BY	MARK	APPR.	DATE						<p>BY: _____ DATE: _____</p>			
DATE	BY	MARK	APPR.	DATE											

